

Parts Kit Information

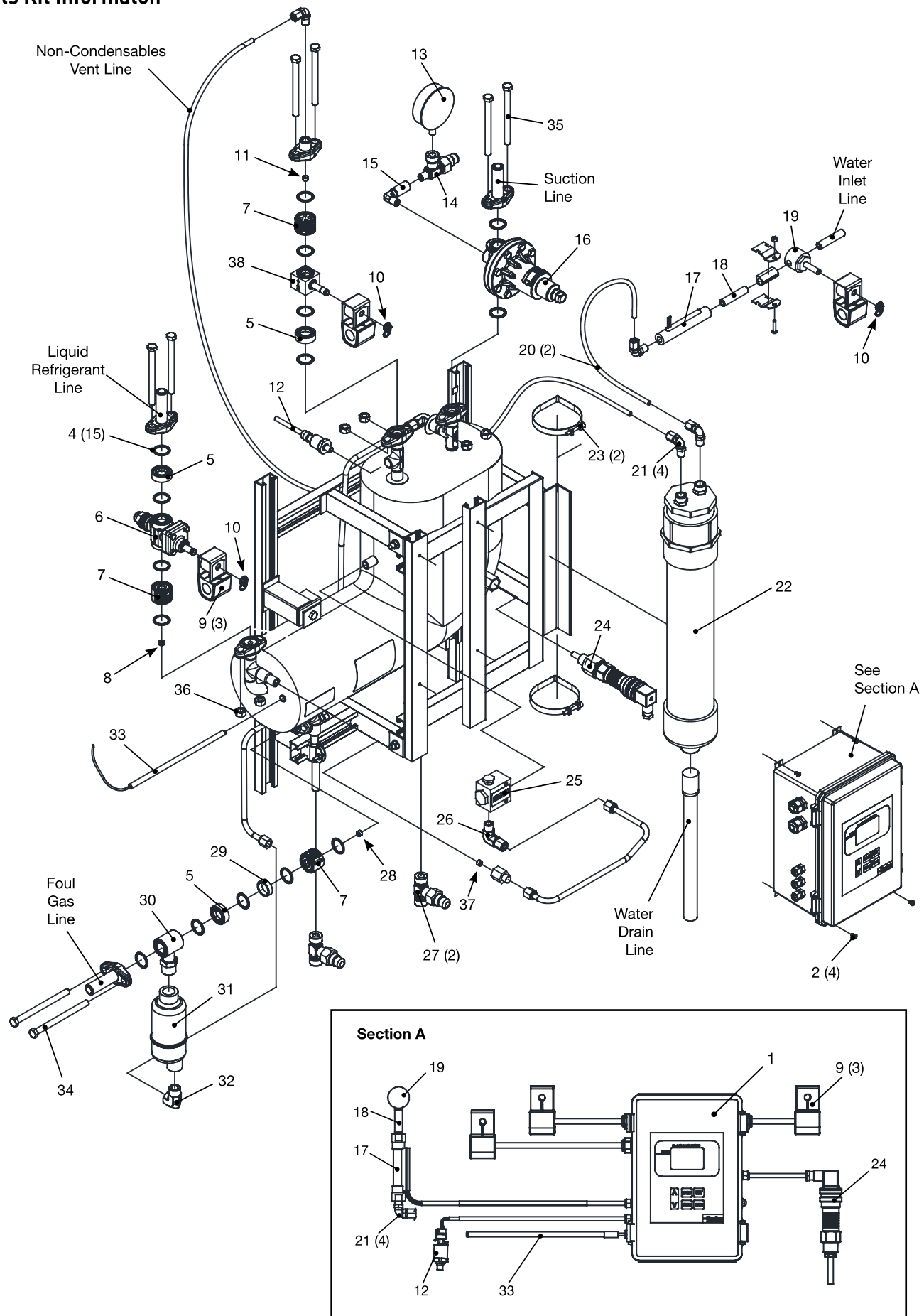

Figure 12: V300 Auto Purger Exploded View

Item	Description	Kit Description	Kit
1	Controller, V300	120V Controller	
2	Connecting Bolts, Controller	4 Point	209898
9(3)	Coil, Solenoid Valve	8 Point	209899
10	Retaining Clip, Coil	12 Point	209900
12	Pressure Transducer	16 Point	209901
17	Flow Switch, Water Line	20 Point	209902
18	Pipe, Threaded	240V Controller	
19	Solenoid Valve, Water Line	4 Point	209924
21	Nylon Connector, Elbow	8 Point	209925
24	Level Switch, HBSR	12 Point	209926
33	Temperature Probe	16 Point	209927
		20 Point	209928
4(12)	Gasket, Flange	Gasket Pkg, Flange	202078
4(2) 5	Gasket, Flange Disc Strainer	Strainer Assembly, Disc	200912
4(2) 6	Gasket, Flange Solenoid Valve, SV2	Solenoid Valve Assembly, Liquid Line	209369
4(2) 7	Gasket, Flange Check Valve, CK4A-2 (1/2" NPT)	Check Valve Assembly	CK413X00NSN
8	Orifice, 0.040" (1/8" NPT)	Plug Pkg, Orifice 0.040"	208667
9 10	Coil, Solenoid Valve Retaining Clip, Coil	Coil Pkg 110-120V ~ 50-60Hz 220-240V ~ 50-60Hz	209073 209074
10(12)	Retaining Clip, Coil	Retaining Clip Pkg	206516
11	Orifice, 0.026" (1/8" NPT)	Plug Pkg, Orifice 0.026"	208665
12	Pressure Transducer	Pressure Transducer	209292
13	Pressure Gauge, Ammonia	Pressure Gauge 760mm - 10.5 bar 30" - 150psig	309403 309401
14	Angle, Unibody (1/4" NPT)	Angle Unibody Asseby	106630
16	Pressure Regulator	Pressure Regulator, A2B RA	209290
17	Flow Switch, Water	Flow Switch Assembly	209324
18 19 21	Pipe, Threaded Solenoid Valve, Water Line Nylon Connector, Elbow	Solenoid Valve Assembly, Water Line	208787
20(6) 21(4)	Nylon Tubing Nylon Connector, Elbow	Nylon Tubing, Bubbler	208668
22	Water Bubbler	Water Bubbler Assembly	208789
24	Level Switch, HBSR	Level Switch Assembly	208790
25	Differential Check Valve, (50psig)	Differential Check Valve Assembly	309657
27	Unibody, Globe (1/4" NPT)	Globe Unibody Assembly	106621
28	Orifice, 0.032" (1/8" NPT)	Plug Pkg, Orifice 0.032"	208666
4(2) 29	Gasket, Flange 13mm (1/2") Ring Adaptor	Ring Adaptor	200095
31	Liquid Drainer	Liquid Drainer	309625
33 [1]	Temperature Probe	Temperature Probe, Sensor	209075
37	Orifice, 0.028" (1/8" NPT)	Plug Pkg, Orifice 0.028"	209365
38	Solenoid Valve, S6P	Solenoid Valve Assembly, Vent Line	208982

Table 3: V300 Rapid Purger Repair Kits

1 Should the RTD require replacement, the factory setting must be changed in order to calibrate the RTD. Close the hand valve for the foul gas inlet and liquid feed inlet. Remove the faulty RTD and connect the replacement RTD to the proper wiring. Place the RTD in a container with ice and water. Observe the temperature reading on the controller screen and wait for it to stabilize. Once the temperature has stabilized change the offset to cause the temperature reading to be 0°C (32°F). Double check the reading in the ice water bath and ensure that the RTD is reading 0°C (32°F). The RTD is now calibrated.